

UNIVERSITY OF ALASKA			
Project Name: UAA Science Renewal			
MAU: UAA			
Building:	Science	Date:	2/25/2009
Campus:	Anchorage	Prepared By:	FP&C
Project #:	564303	Account No.:	564303
Total GSF Affected by Project:		27,166 sf	
PROJECT BUDGET			Original
A.	Professional Services		
	Consultant Basic Services		\$1,000,000
	Consultant Extra Services		\$0
	Site Survey		\$30,000
	Soils Engineering		\$0
	Testing		\$80,000
	Plan Review / Permits	2%	\$174,720
	Other		\$0
	Professional Services Subtotal		\$1,284,720
B.	Construction		
	General Contractor		\$7,800,000
	Construction Contingency	12%	\$936,000
	Art		\$0
	Construction Subtotal		\$8,736,000
	Construction Cost per GSF		\$322
C.	Equipment and Furnishings		
	Equipment	3%	\$262,080
	Furnishings	4%	\$349,440
	Move In	3%	\$262,080
	Equipment and Furnishings Subtotal		\$873,600
D.	Administrative Costs		
	Misc. Expenses		\$68,880
	Project Management	5%	\$436,800
	Administrative Costs Subtotal		\$505,680
E. Total Project Cost			\$11,400,000
Total Project Cost per GSF			\$420
F. Total Appropriation(s)			\$11,400,000

UNIVERSITY OF ALASKA		
Project Name: UAA Science Renewal - Phase 1		
MAU: UAA		
Building:	Science	Date: 2/25/2009
Campus:	Anchorage	Prepared By: FP&C
Project #:	564303	Account No.: 564303
Total GSF Affected by Project:		27,166 sf
PROJECT BUDGET		Original
A.	Professional Services	
	Consultant Basic Services	\$1,000,000
	Consultant Extra Services	\$0
	Site Survey	\$30,000
	Soils Engineering	\$0
	Testing 2%	\$50,000
	Plan Review / Permits 4%	\$67,200
	Other	\$0
	Professional Services Subtotal	\$1,147,200
B.	Construction	
	General Contractor	\$1,500,000
	Construction Contingency 12%	\$180,000
	Art	\$0
	Construction Subtotal	\$1,680,000
	Construction Cost per GSF	\$62
C.	Equipment and Furnishings	
	Equipment 0%	\$0
	Furnishings 0%	\$0
	Move In 0%	\$0
	Equipment and Furnishings Subtotal	\$0
D.	Administrative Costs	
	Misc. Expenses	\$127,800
	Project Management 3%	\$45,000
	Administrative Costs Subtotal	\$172,800
E. Total Project Cost		\$3,000,000
Total Project Cost per GSF		\$110
F. Total Appropriation(s)		\$3,000,000

Plot Date: Mar 03, 2009 - 4:35pm
Drawing File: x:\2008\08076.01 UAA Science Backfill\dwg\1-SD\PreDesign\08076.01-Bubble-UpperLevel.dwg

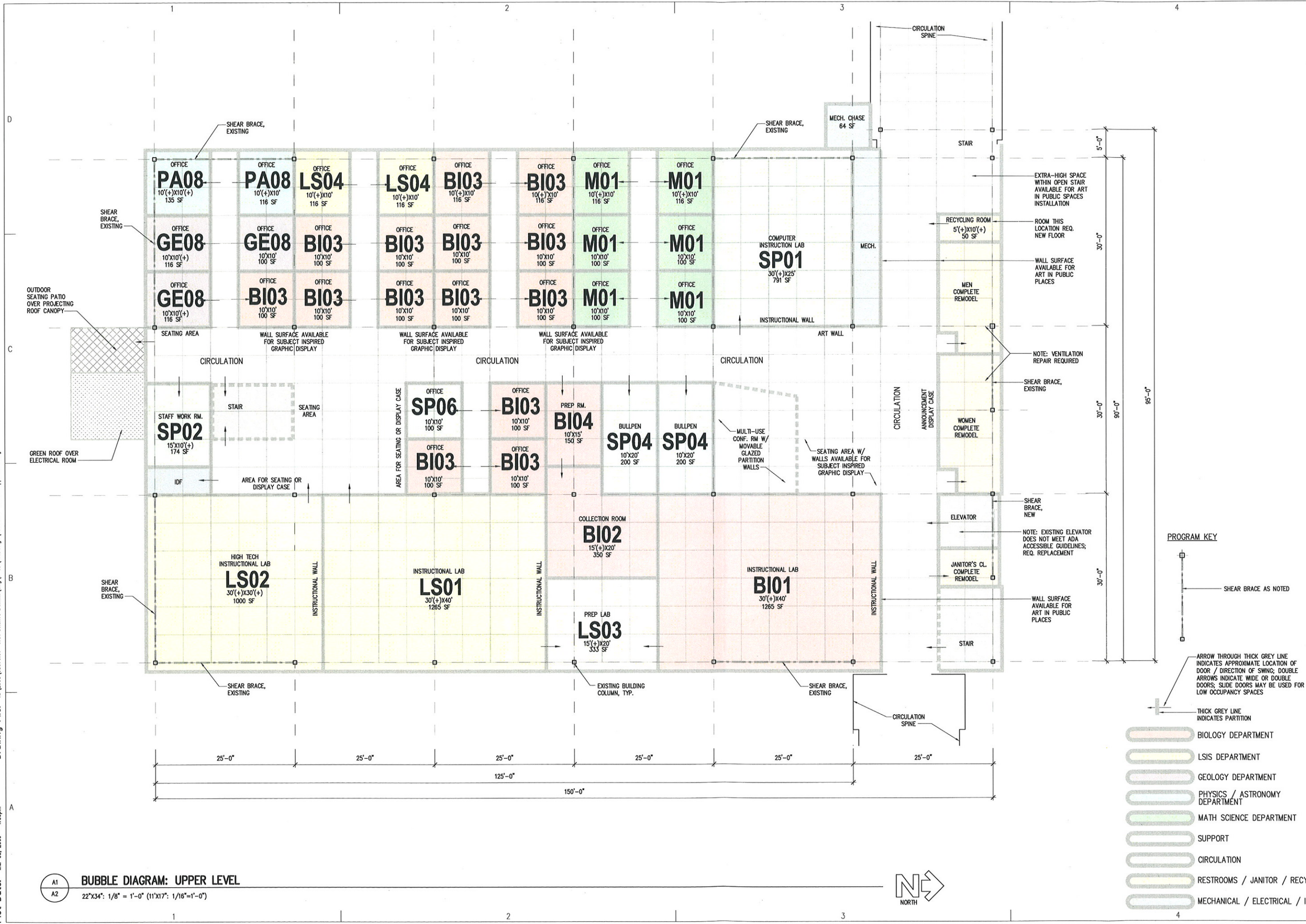

BUBBLE DIAGRAM: UPPER LEVEL

22'x34': 1/8" = 1'-0" (11'x17": 1/16"=1'-0")

Architects Alaska, Inc.
architectsalaska.com
900 W. 5th Ave, Suite 403
Anchorage, Alaska 99501-2029
907.272.3567 • 907.277.1732 fax
191 E. Swanson Ave, Suite 203
Wasilla, Alaska 99654-7025
907.373.7503 • 907.376.3166 fax

Consultant

UNIVERSITY OF ALASKA ANCHORAGE
UAA SCIENCE BACKFILL
SCIENCE BUILDING REMODEL
ANCHORAGE, ALASKA

Revisions		
No.	Description	Date

Drawn by BCM	Date 02.27.09
Checked DM	Job No. 08076.01

Sheet Contents
PLAN: SECOND FLOOR

Category	Sheet No.
A	2