



## ***SCHEMATIC DESIGN APPROVAL***

**Name of Project:** UAA Science Renovation

**Location of Project:** Anchorage, Alaska

**Project Number:** 564303

**Date of Request:** May 6, 2009

<b>Estimated Total Project Cost:</b> \$11,400,000
<b>Approval Required:</b> F&LM Committee

### **Supporting Documents**

1. Budget
2. Cost Estimate Summary
3. Site Plan
4. Lower Level Floor Plan
5. Upper Level Floor Plan
6. Elevations (all sides)
7. Sections (one cross section and one longitudinal section)
8. Wall Section(s)

<b>UNIVERSITY OF ALASKA</b>			
Project Name: <b>UAA Science Renewal</b>			
MAU: UAA			
Building:	Science	Date:	2/25/2009
Campus:	Anchorage	Prepared By:	FP&C
Project #:	564303	Account No.:	564303
Total GSF Affected by Project:		27,166 sf	
<b>PROJECT BUDGET</b>			Original
<b>A.</b>	<b>Professional Services</b>		
	Consultant Basic Services		\$1,000,000
	Consultant Extra Services		\$0
	Site Survey		\$30,000
	Soils Engineering		\$0
	Testing		\$80,000
	Plan Review / Permits	2%	\$174,720
	Other		\$0
	Professional Services Subtotal		\$1,284,720
<b>B.</b>	<b>Construction</b>		
	General Contractor		<b>\$7,800,000</b>
	Construction Contingency	12%	\$936,000
	Art		\$0
	Construction Subtotal		\$8,736,000
	Construction Cost per GSF		\$322
<b>C.</b>	<b>Equipment and Furnishings</b>		
	Equipment	3%	\$262,080
	Furnishings	4%	\$349,440
	Move In	3%	\$262,080
	Equipment and Furnishings Subtotal		\$873,600
<b>D.</b>	<b>Administrative Costs</b>		
	Misc. Expenses		\$68,880
	Project Management	5%	\$436,800
	Administrative Costs Subtotal		\$505,680
<b>E. Total Project Cost</b>			<b>\$11,400,000</b>
Total Project Cost per GSF			\$420
<b>F. Total Appropriation(s)</b>			<b>\$11,400,000</b>

**UAA Science Backfill**  
**Science Building Remodel**  
**Prepared for Architects Alaska by Estimations**

**Construction Cost Estimate**  
**Schematic Rescope Submittal**  
**April 23, 2009**

Description	Estimated Cost Plus		Div.
	Estimated Cost	Contingency & Escalation	
<b>Basic Bid</b>			
01 - GENERAL REQUIREMENTS	\$1,189,631	\$1,354,394	1
02 - SITEWORK	\$547,699	\$623,555	2
03 - CONCRETE	\$11,598	\$13,204	3
04 - MASONRY	\$0	\$0	4
05 - METALS	\$340,019	\$387,112	5
06 - WOOD AND PLASTIC	\$183,687	\$209,128	6
07 - THERMAL & MOISTURE PROTECTION	\$80,193	\$91,300	7
08 - DOORS AND WINDOWS	\$246,913	\$281,110	8
09 - FINISHES	\$812,784	\$925,355	9
10 - SPECIALTIES	\$86,337	\$98,295	10
11 - EQUIPMENT	\$118,947	\$135,421	11
12 - FURNISHINGS	\$487,592	\$555,123	12
13 - SPECIAL CONSTRUCTION	\$131,889	\$150,156	13
14 - CONVEYING	\$80,000	\$91,080	14
15 - MECHANICAL	\$1,501,961	\$1,709,983	15
16 - ELECTRICAL	\$943,634	\$1,074,327	16
<b>Total Estimated Construction Cost - Basic Bid:</b>	<b>\$6,762,884</b>	<b>\$7,699,543</b>	<b>&lt;&lt;&lt;&lt;&lt;</b>
<b>Additive Alternate</b>			
<b>A1 - CCTV Security</b>	<b>\$118,726</b>	<b>\$135,169</b>	<b>&lt;&lt;&lt;&lt;&lt;</b>

Estimating Contingency: 12 Mths @ 3.5% 10.0%  
Escalation For Inflation: 3.5%





### CODE INFORMATION

LANE 0' NON  
 EXIT ROADWAY  
 FREE DEMONSTRATION  
 FREE DEMONSTRATION  
 ILLUMINATED EXIT SIGN  
 SQUARE FOOTAGE: 110 SQUARE FEET (10.2421)

Revisions		
No.	Description	Date

Drawn by	Date
SAS	04.24.09
Checked	Job No.
DW	00078.01

Sheet Contents	
1st SURF ROOM PLANS	
RFS1 ROOM	

Category	Sheet No.
A	1.0

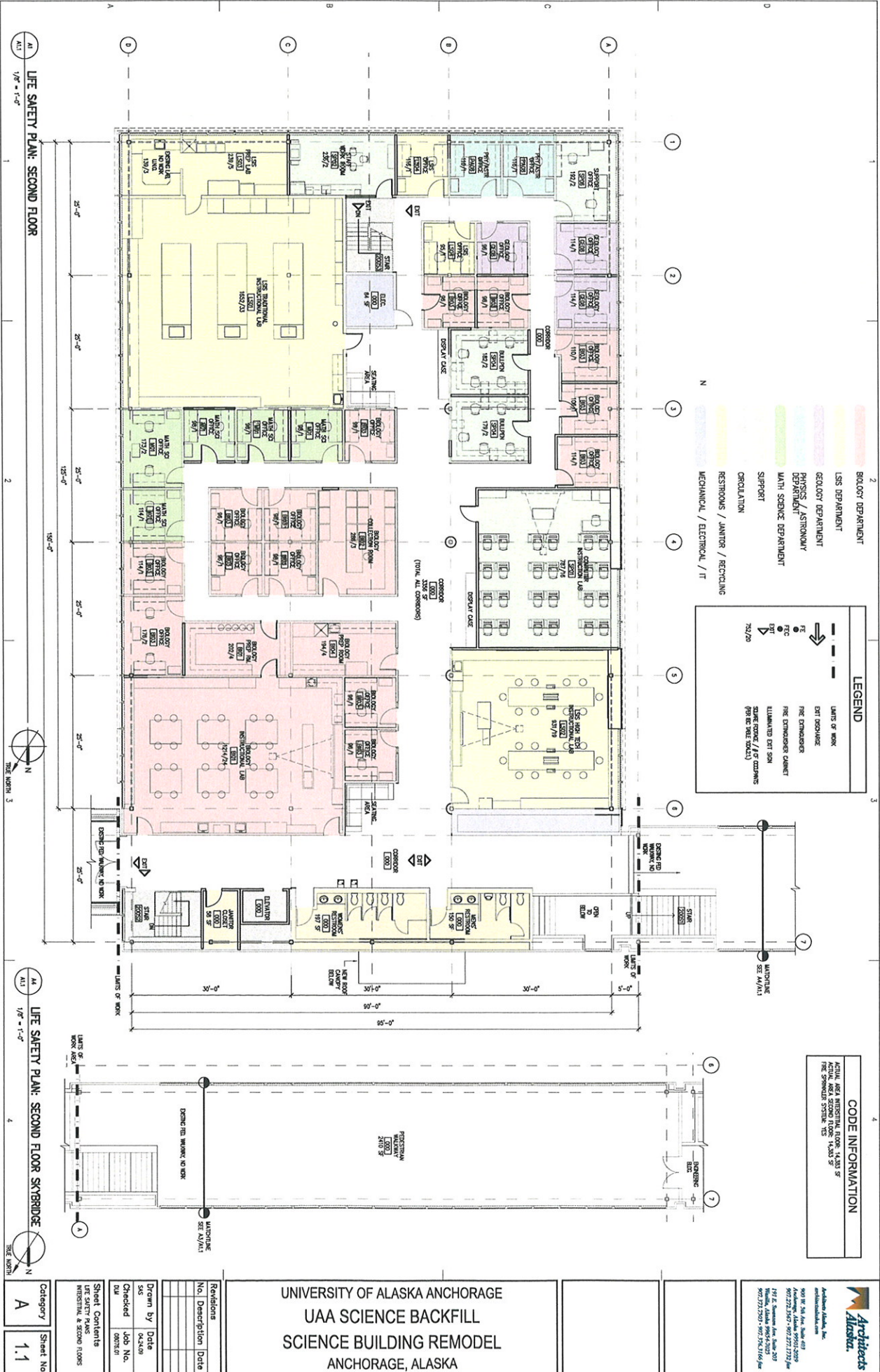

## SHEET NOTES

- [illegible]

## SHEET NOTES

- [illegible]

A1	A2.3
----	------

[illegible]

